



# Year 6 Geography

## Our Changing World / Local Area Study

### Things you should already know;

- What is geography?
- How to use an Ordnance Survey map and 6 figure grid references.
- To use an atlas to locate countries

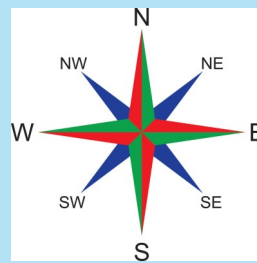

### Key Skills

- Use an atlas to identify countries, states and regions of the UK.
- Understand why keys are necessary and use them to help read maps
- Use fieldwork skills to collect & record evidence relating to local human and physical geography.
- Use eight points of a compass, symbols and keys to build knowledge of the local area.
- Use 6 and 8 figure grid references.

### New Learning for Year 6

#### Coastal Features:

- Understand and explain the terms 'weathering' and 'erosion'.
- Identify and describe different types of weathering.
- Describe how different types of weathering change rocks & coastal landscapes over time.
- Describe how erosion changes rocks & coastal landscapes over time.
- Name some features of a coastline.
- Explain how some coastal features are formed.
- Explain how erosion and deposition form coastal features.
- Describe some famous UK coastal features.
- Identify the location of some famous UK coastal features using maps, atlas and online mapping tools.
- Explain the effects of erosion and deposition caused by waves and tides over time.
- Use diagrams to explain longshore drift.
- Use geographical knowledge to predict how coastlines looked in the past, how they may change in the future and why some coastlines change rapidly.

#### Local Area Study:

- Identify and describe human and physical geographical changes over time in the local area
- Explore and describe different types of land use in the local area, how they have changed over time and the reasons for these changes taking place.
- Compare similarities and differences between the immediate local area and other localities using a range of geographical information sources including maps, digital/online mapping systems and aerial photographs alongside fieldwork observations, charts, graphs and model building.
- Create land-use maps of the local area using sketches and photos collected during field study alongside other geographical sources of information.
- Create then and now maps to identify key aspects of land use change.

### Key Vocabulary

|                              |  |
|------------------------------|--|
| <b>Weathering</b>            | The process of wearing away rocks by the weather.  |
| <b>Physical weathering</b>   | Water gets into cracks in the rock, it can then freeze causing the water to expand, creating cracks in the rocks.  |
| <b>Chemical weathering</b>   | Slightly acidic rainwater can cause a chemical reaction and over time can dissolve some of the rock.   |
| <b>Biological weathering</b> | Caused by animals and plants. Roots can grow under rocks and cause damage, animals can wear paths, dig holes, etc.   |
| <b>Acidic</b>                | A chemical substance, usually a liquid, which reacts with other substances to form salts. Some acids burn or dissolve other substances that they come into contact with. |
| <b>Dissolve</b>              | When a solid substance mixes with a liquid to make a solution.   |
| <b>Erosion</b>               | When natural materials are worn away and transported to a different place.   |
| <b>Deposition</b>            | When material/sediment is moved and dropped off in a different place.  |
| <b>Border/Boundary</b>       | The outer part or edge of a region or country that divides it from another.  |
| <b>Physical geography</b>    | The study of Earth's natural features such as mountains, rivers, deserts, oceans, etc.   |
| <b>Human geography</b>       | The study of where people live, what they do and how they use the land.  |



# Year 6 Geography

## Our Changing World / Local Area Study

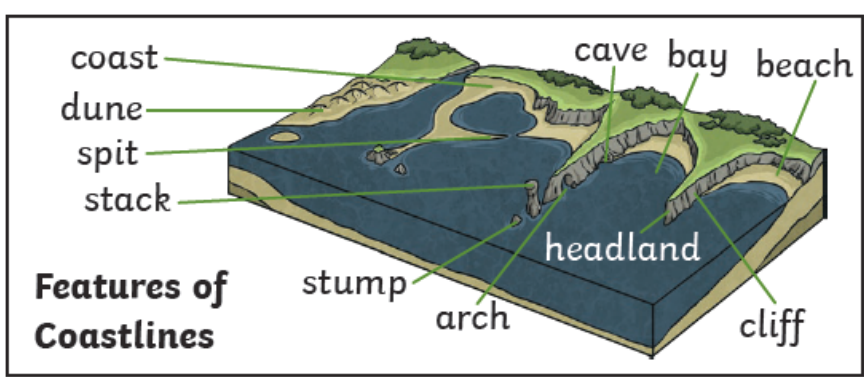

**Sticky Learning.**  
 Can you answer any of these questions in your book?

Many countries and their borders across the world have and are still changing. Can you explain how human/ political activity and natural activity can have an impact on the borders, language, religion and culture of the country?

Can you describe the weathering that is happening in these 3 pictures and how it is caused?

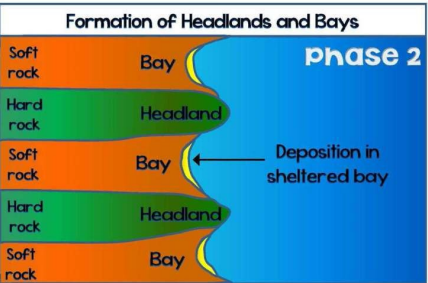
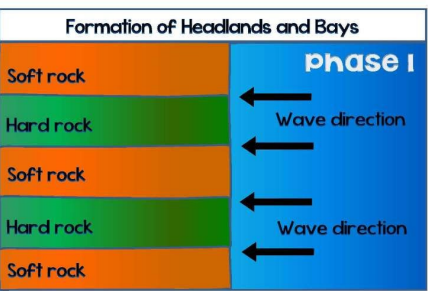

**Arches, Stacks and Stumps**

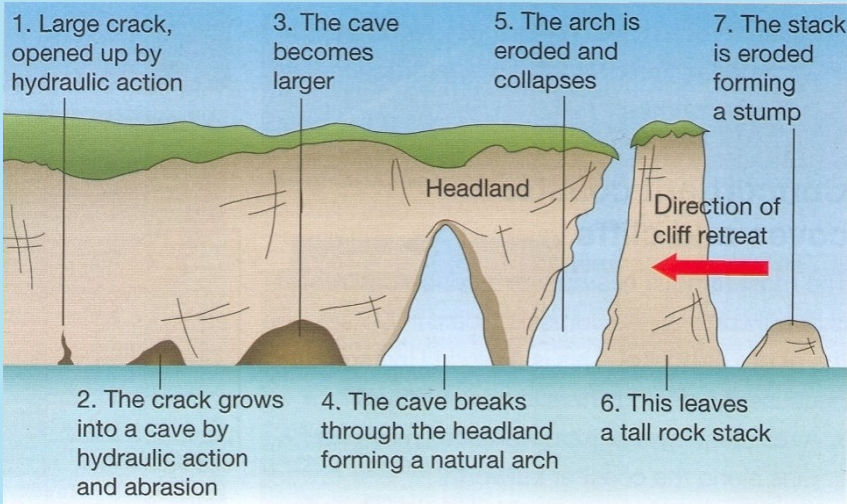

Can you draw your own map of the school or Potten End?

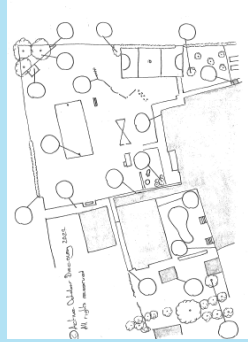

Find a local picture of Potten End and label its physical and human geography features.

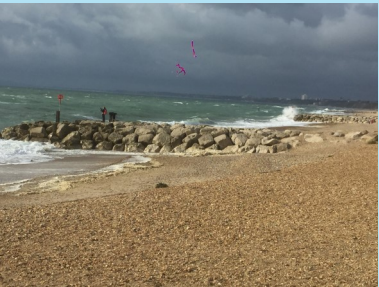
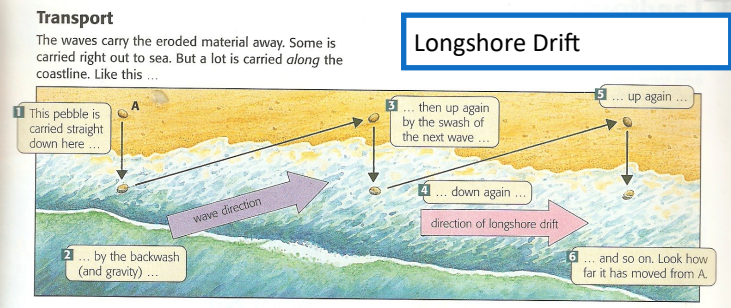

Take a quiz on coastlines



Take a quiz on longshore Drift

